

DRAWING MADE IN THIRD ANGLE PROJECTION

© COPYRIGHT 1978 BY AMP INCORPORATED, HARRISBURG, PA. ALL INTERNATIONAL RIGHTS RESERVED. AMP INCORPORATED PRODUCTS COVERED BY U. S. AND FOREIGN PATENTS AND/OR PATENTS PENDING.

- △ SHEET METAL SCREWS NOT SUPPLIED. INSERT IS ATTACHED TO STRAIN RELIEF. AS AN ADDITIONAL ADJUSTMENT FOR SMALL WIRE BUNDLES, IT SHOULD BE CUT OFF AND POSITIONED AS SHOWN BY DOTTED LINES.
- △ TWO REQUIRED PER CONNECTOR.
- 4. DETACHABLE INSERT MAY SEPARATE FROM STRAIN RELIEF BODY DURING SHIPPING.

REVISIONS		DATE	APPROVED
P	F		
1	REVISED AND REDRAWN PER M-5186	3-2-79	MSE/DH
2	AI RESTORATION	3-28-79	ST/ED
3	B REV PER ECN CM 705	3-18-80	TR/R5

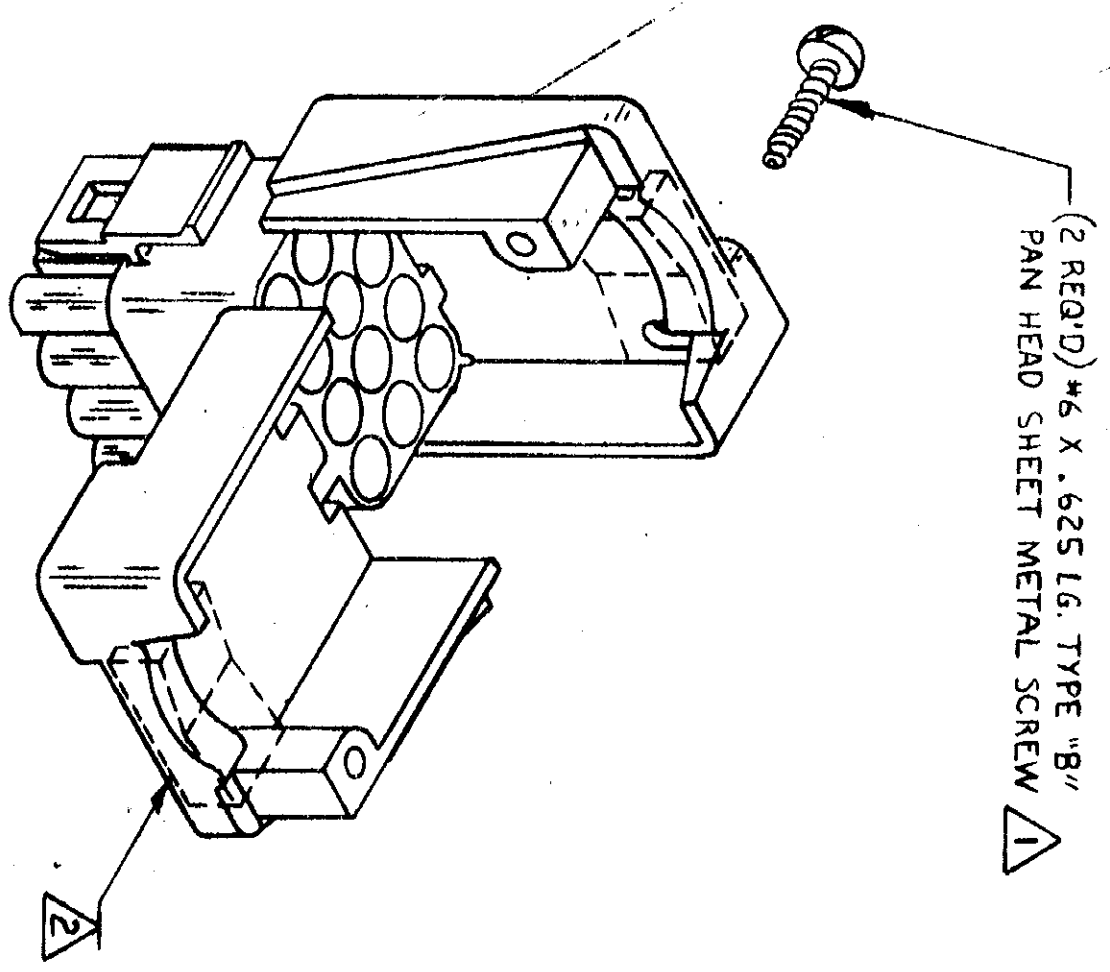
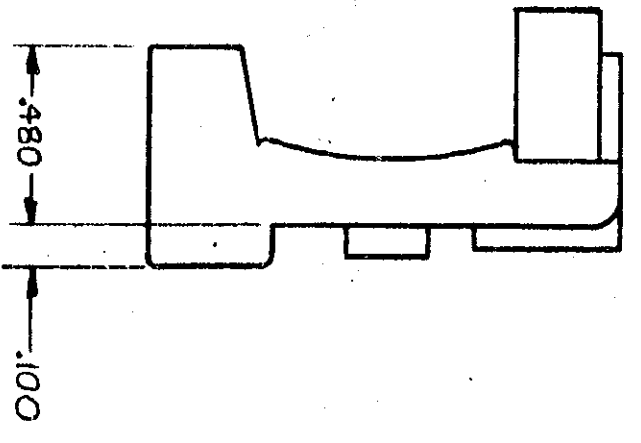
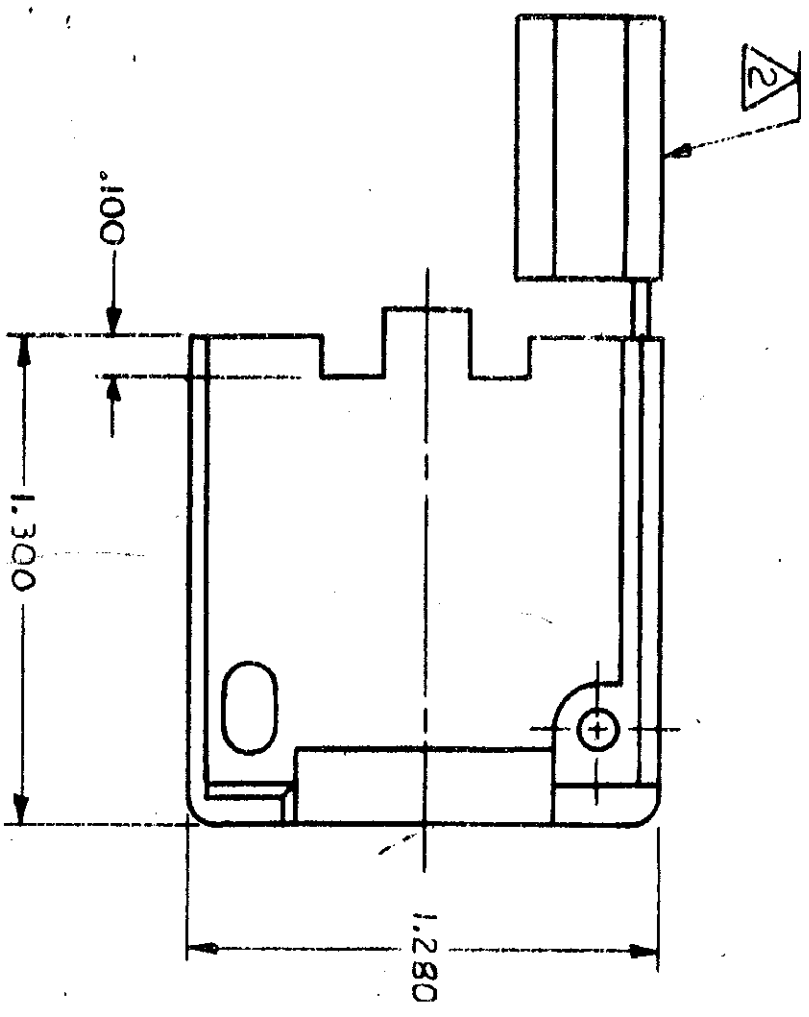
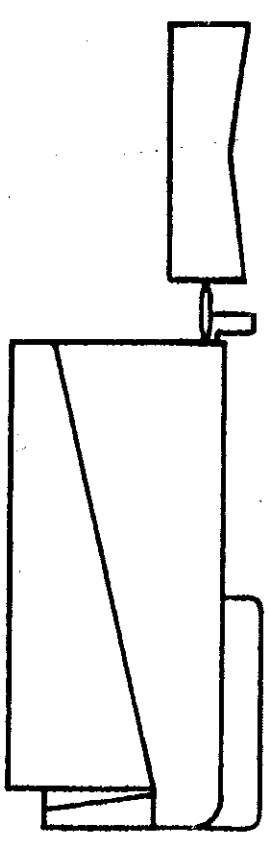

640723

WIRE BUNDLE DIA	WITHOUT INSERT	WITH INSERT
	.750 MAX	.150 MIN

UNLESS OTHERWISE SPECIFIED DIMENSIONS ARE IN INCHES. TOLERANCES ON: DECIMALS ± .015 ANGLES ± .015

FINISH: SEE TABLE  
MATERIAL: SEE TABLE

CONTRACT NO: 3-2-79  
DR: M. FEHER  
CHK: J.S. Wade 3/22/79  
APPD: J.C.P. 3-22-79  
APPD: [Signature] 3-22-79  
DSGN APPD: [Signature]  
OTHER APPD:

NAME: STRAIN RELIEF FOR 12 CIRCUIT UNIVERSAL MATE-N-LOK™ CONNECTOR

NATURAL COLOR MATERIAL: NYLON 94V-2 | 640723-0/3  
SCALE: 2-1  
SIZE CODE IDENT NO: 00779  
DRAWING NO: 640723  
SHEET: 1 OF 1

CUSTOMER DRAWING